

AED PLACEMENT & COVERAGE GUIDE

Ensuring Fast, Effective Response to Sudden Cardiac Arrest

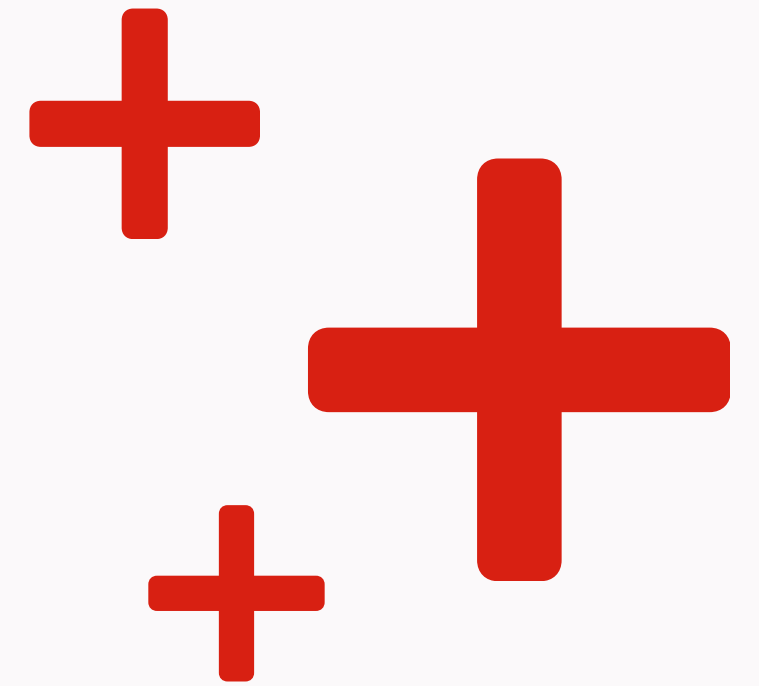
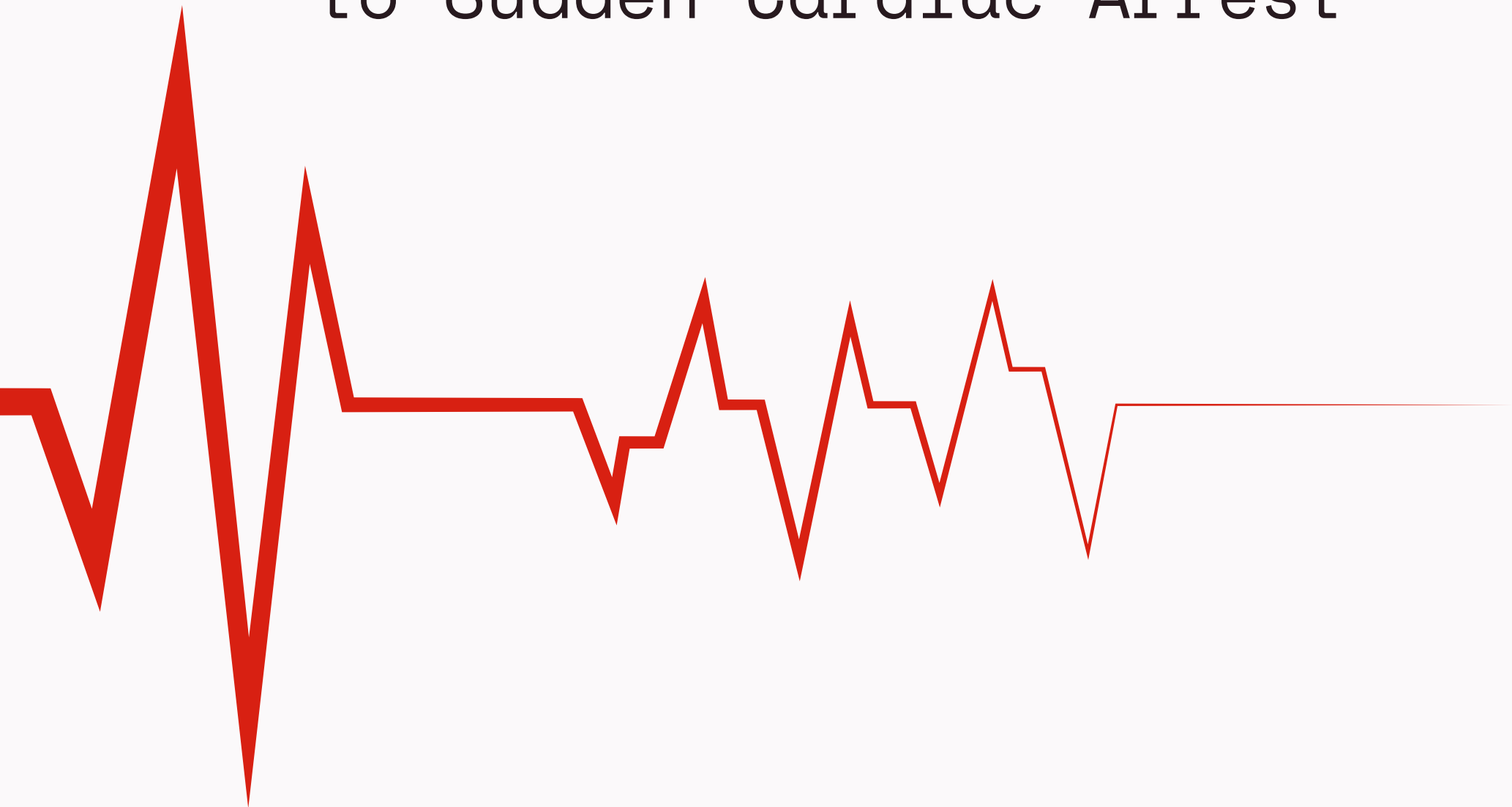

EVERYBEAT

Why AED Placement Matters



- 350,000+** cardiac arrests occur annually in the U.S.
- Survival drops **10% every minute** without defibrillation
- Brain damage begins at **4-6 minutes**
- AED use within **3 minutes** can raise survival to **70%+**

Proper placement = faster response = more lives saved

The 3-Minute Rule

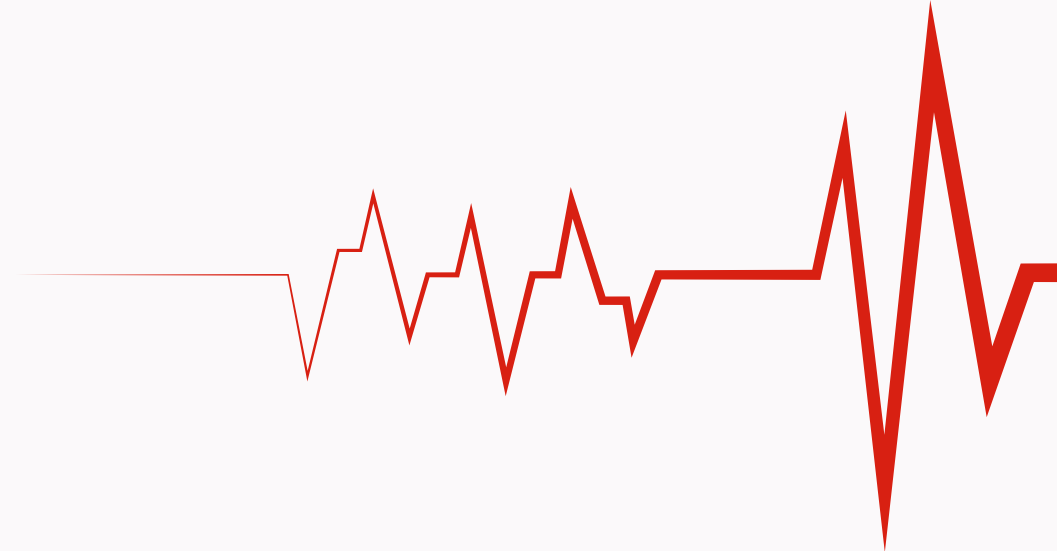

Your AED must be reachable within 3 minutes from anywhere in the facility.



If any area exceeds 3 minutes  Add another AED

How to Calculate AED Coverage

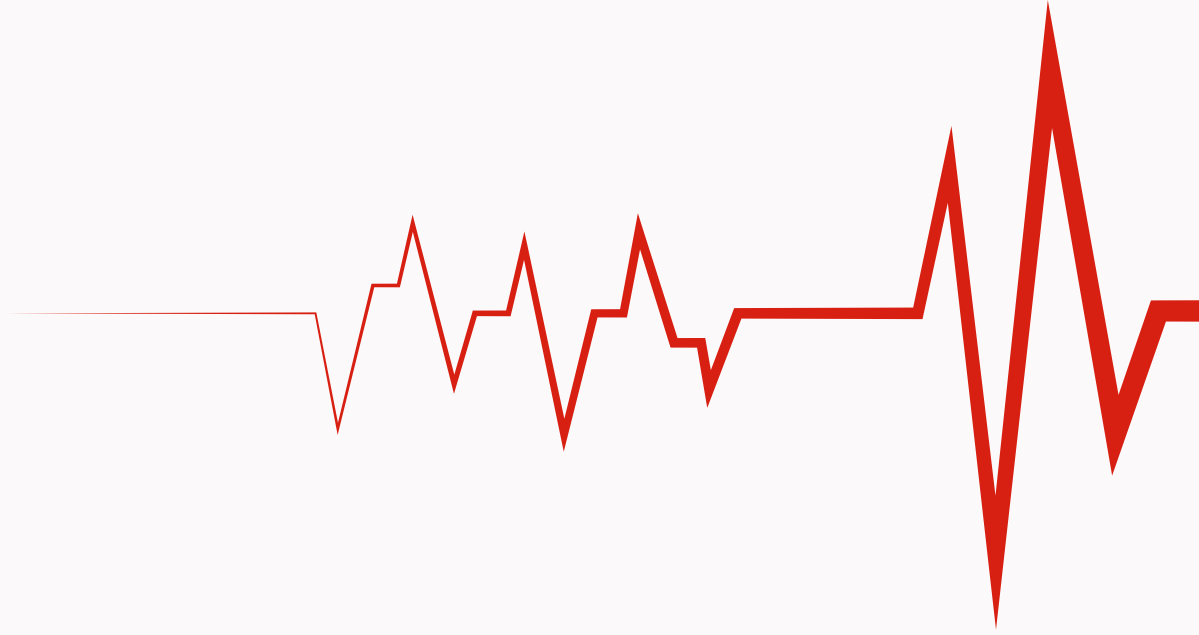

Key Factors

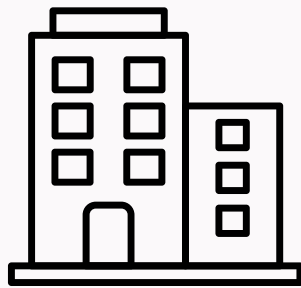

Total Square Footage

- Under 10,000 sq ft → 1 AED
- 10,000-50,000 sqft → 2-3 AEDs
- 50,000-100,000 sqft → 3-5 AEDs
- Over 100,000 sqft → 1 AED per 50,000 sqft

Each floor requires its own AED



Number of Floors

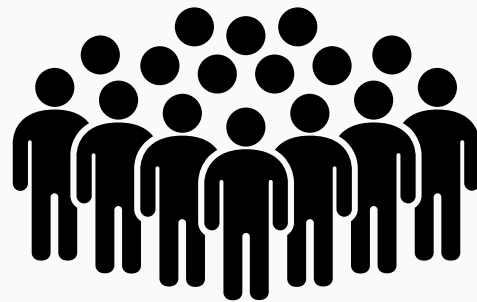

Occupancy Density

- 1 AED per 75-100 occupants
- 1 additional AED for 100 people above baseline
- High-turnover environments (gyms, schools, arenas, etc) require 1 AED per zone
- Any area with consistent crowds (lobbies, cafeterias, etc) should have its own AED
- Indoor/Outdoor areas should each have their own AED

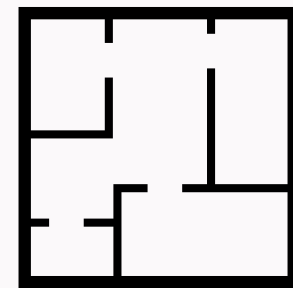

Facility Layout & Walking Paths



High-risk, High-Traffic Zones

- Place AEDs near:
- Fitness Centers
 - Manufacturing floors
 - Senior activity areas
 - Auditorium & Event Spaces
 - Cafeterias & Break Rooms
 - Security Checkpoints
 - Hallway Intersections

AED Signage Requirements



ANSI Z535-compliant Signage Standards

- Use ANSI Z535-compliant AED Signs
- Approved color schemes: Green/White or Red/White
- Must include AED symbol and heart + lightning bolt icon
- Use directional arrows when AED is not directly visible

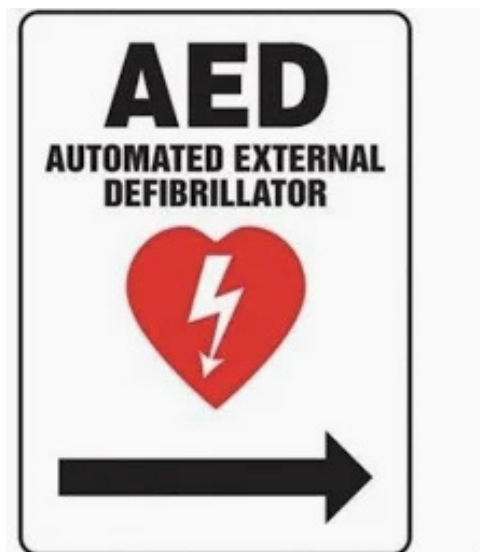

Placement Guidelines

- Above the AED cabinet at eye level
- Add directional signs at hallway intersections
- Place signage near elevators and stairwells
- Waterproof signage with reflective material for outdoor AEDs
- AED signage visible from 180°
- Use same style of signage throughout the facility

Common Mistakes to Avoid

- No signage at all
- AED hidden behind furniture or decor
- AED placed in a cabinet with no external signage
- Directional arrows pointing the wrong way
- Signage placed too high or too low



AED Placement Checklist

✓ Reachable within 3 minutes

✓ Visible and unobstructed

✓ ADA compliant mounting height

✓ Located in high-traffic areas

✓ Signage installed

✓ Included in EAP

✓ Staff trained on AED location



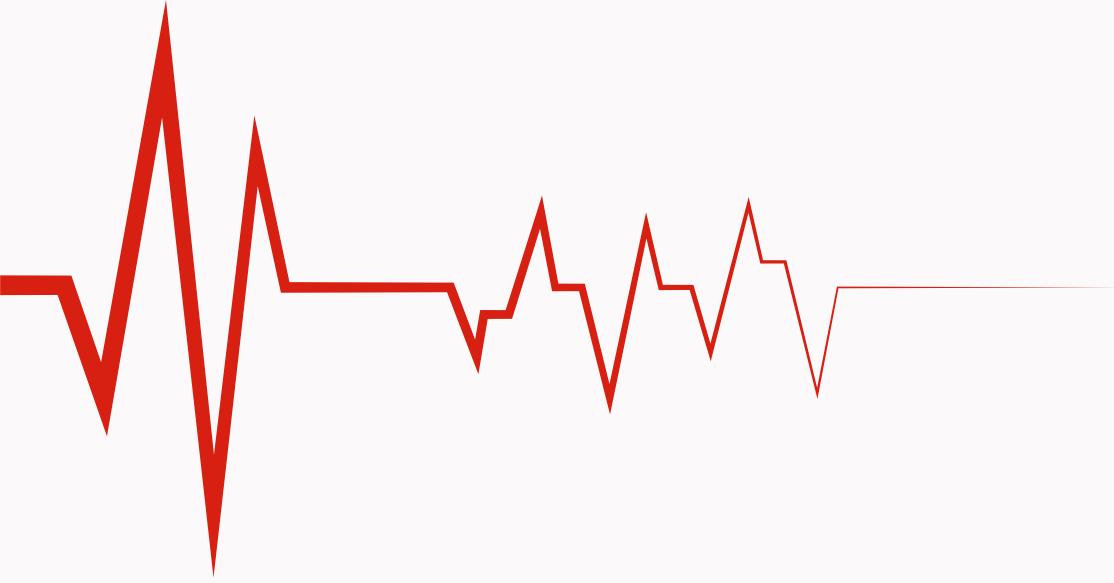

EveryBeat AED Program Support

EveryBeat provides:

- AED placement assistance
- Professional installation (NC only)
- Signage and Cabinet Solutions
- Compliance Guidance
- Ongoing maintenance and monitoring



**BE PREPARED
SAVE A LIFE**



EVERYBEAT

PROTECTING LIFE - ONE BEAT AT A TIME



828-229-5045



www.everybeatllc.com



contact@everybeatllc.com